

# Konica Minolta Mobile Print App

## Advanced Functions & Operations

# Installing the App - Download from “Store”

1. Open Store application on a mobile device
2. Search for “Konica Minolta Mobile Print” using keyword “Konica Minolta”
3. Download and install Konica Minolta Mobile Print

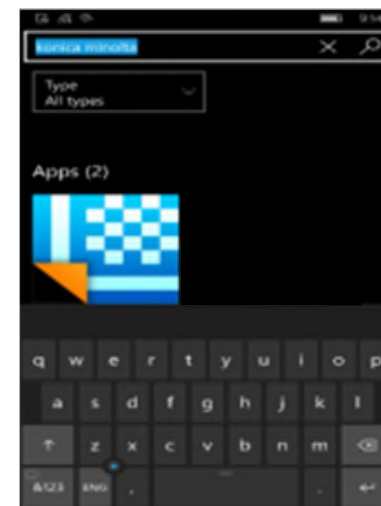
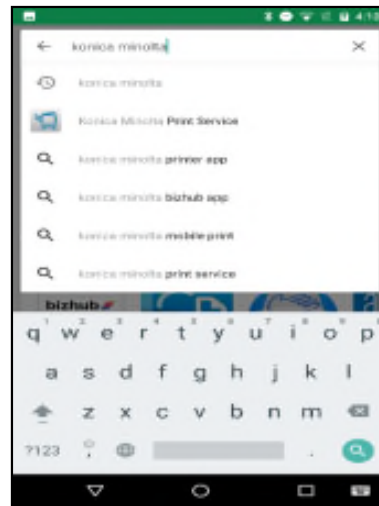
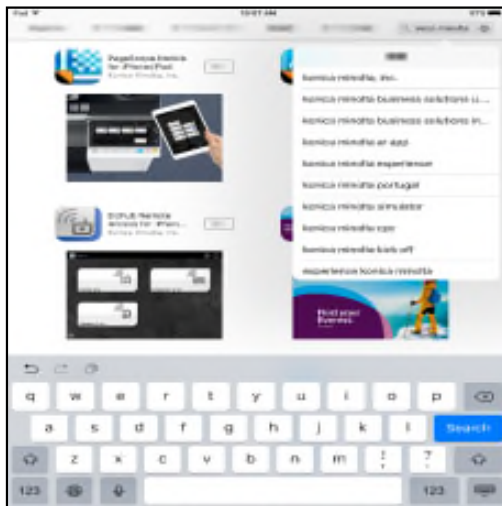

# Application Start Up



## Google Analytics User Approval

After installing the Konica Minolta Mobile Print, a screen confirming the User's cooperation to gather quality improvement information will be displayed.

Konica Minolta collects utilization data, aiming at improving the quality of the application. In an effort to gather Universal Analytics to study data, the information collected is sent to Google.

The Konica Minolta Mobile Print application can still be used if CANCEL is selected. Under these conditions no user utilization data will be sent to Google.

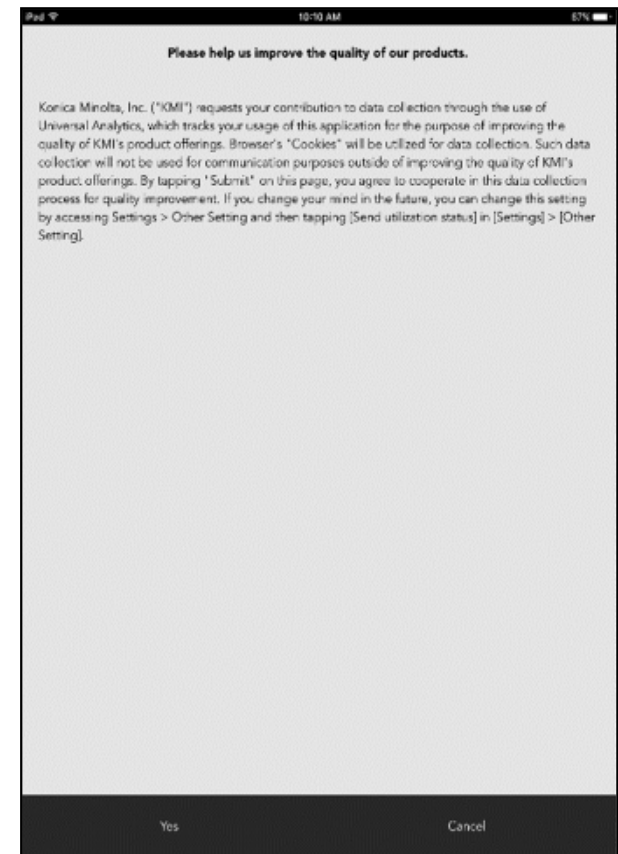

# Application Interface

## iOS Interface



## Android Interface



Commonality between iOS & Android interfaces.

# Advanced Functions – iOS

To use OpenIn function, turn on “Konica Minolta Mobile Print” in the OpenIn menu.

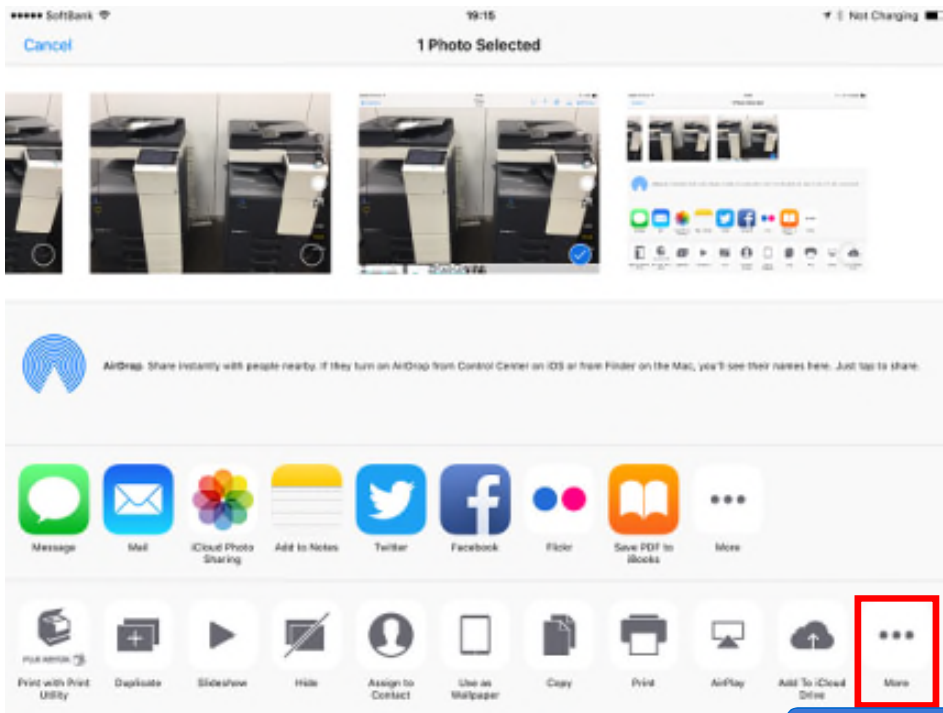

Tap MORE

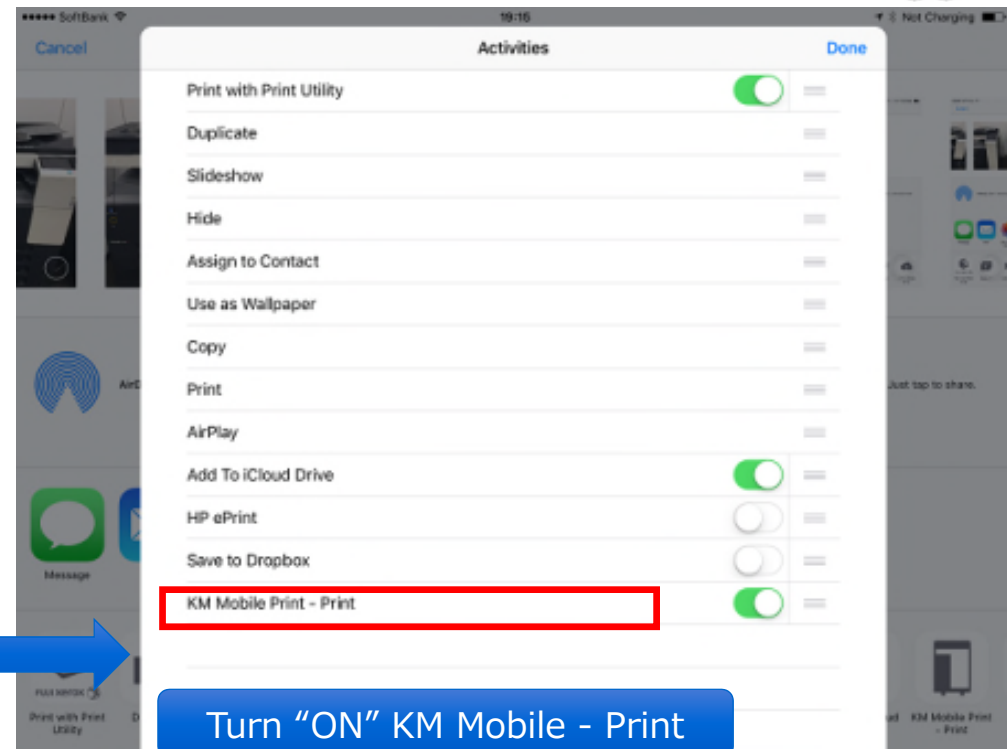

Turn "ON" KM Mobile - Print

# Advanced Functions – Android



To use Printing framework function, turn on the “Konica Minolta Mobile Print” in Android device menu.

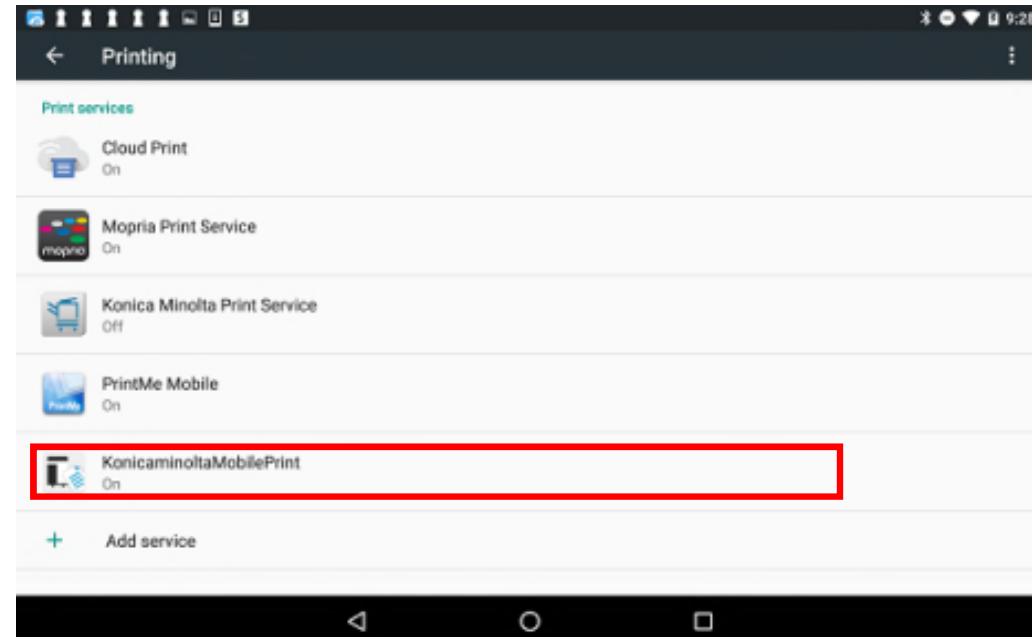
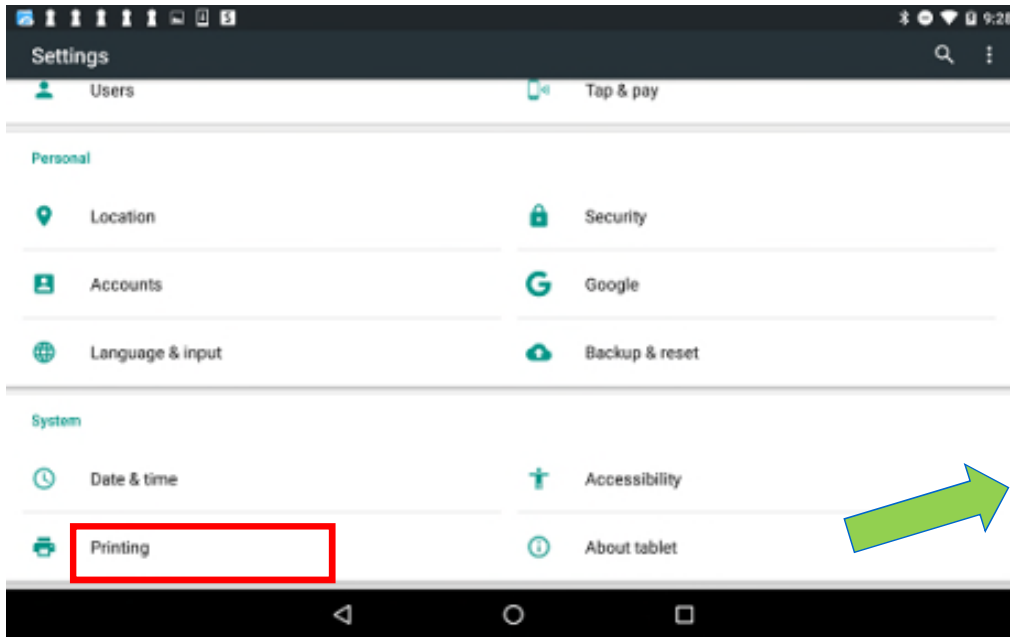

Tap Printing (Settings Menu)

Turn “ON” Konica Minolta Mobile Print

# Printing Mail - iOS

## Mail Account must be Registered

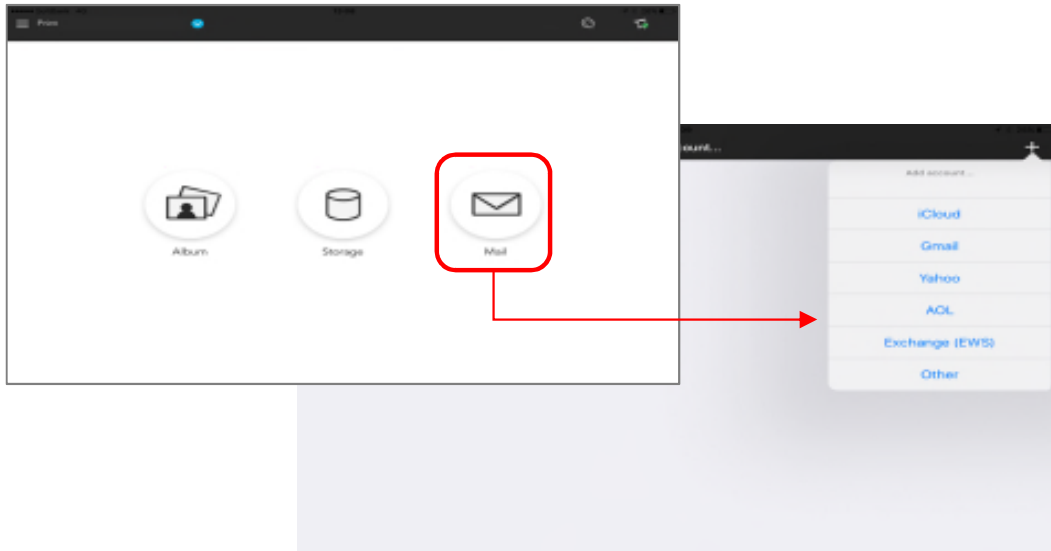

Register Mail Account  
→Gmail, Yahoo, iCloud, Exchange etc.

## Printing Mail using Konica Minolta Mobile Print App



Open Email and tap Print

# Printing Mail - iOS

## AIRPRINT

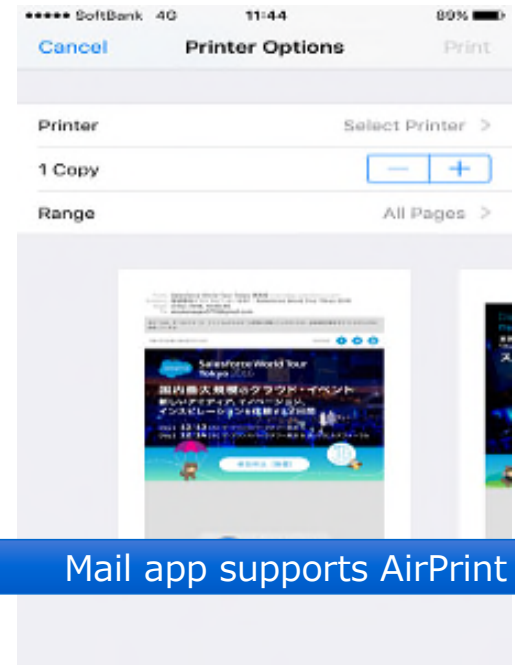
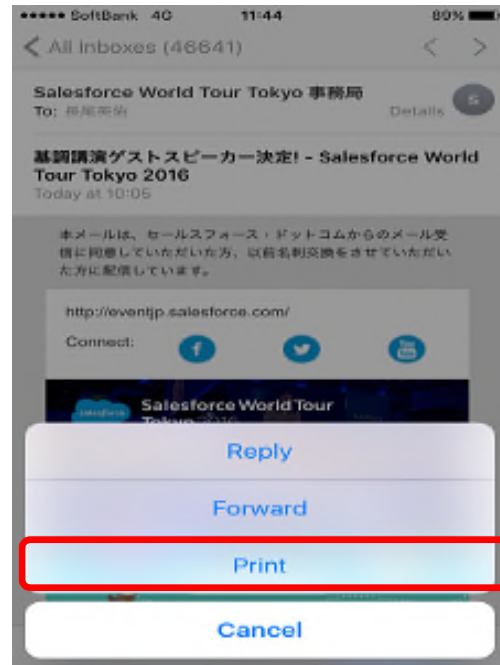

The iOS platform does NOT support the OpenIn function for MAIL (i.e. Gmail App, MS Office Mail). Emails can be printed using AirPrint. MS Office Word, Excel, PPT support the OpenIn function as well as AirPrint function.



# Printing Mail - Android

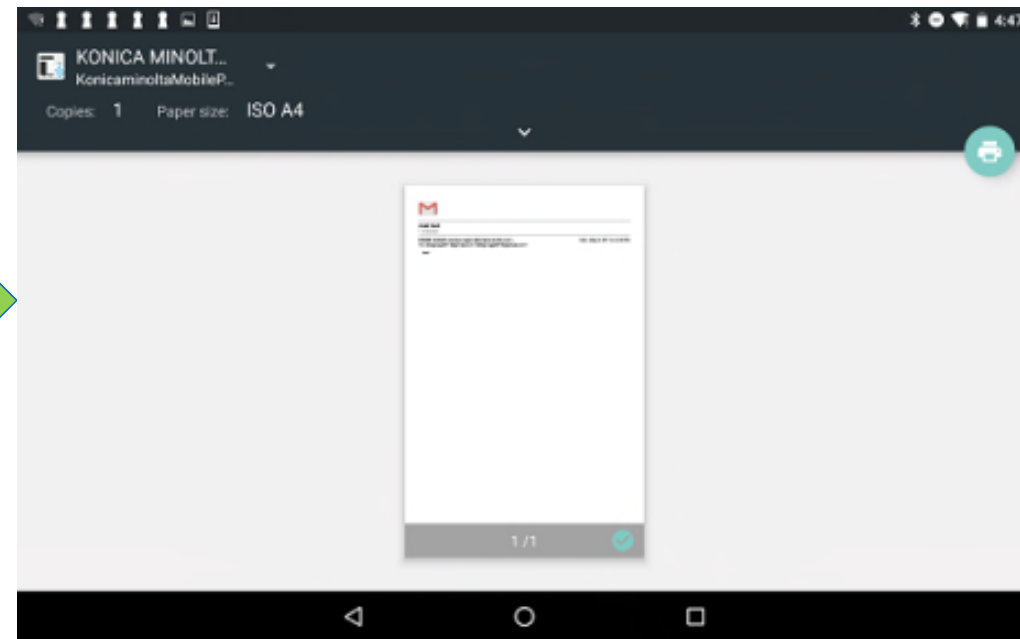
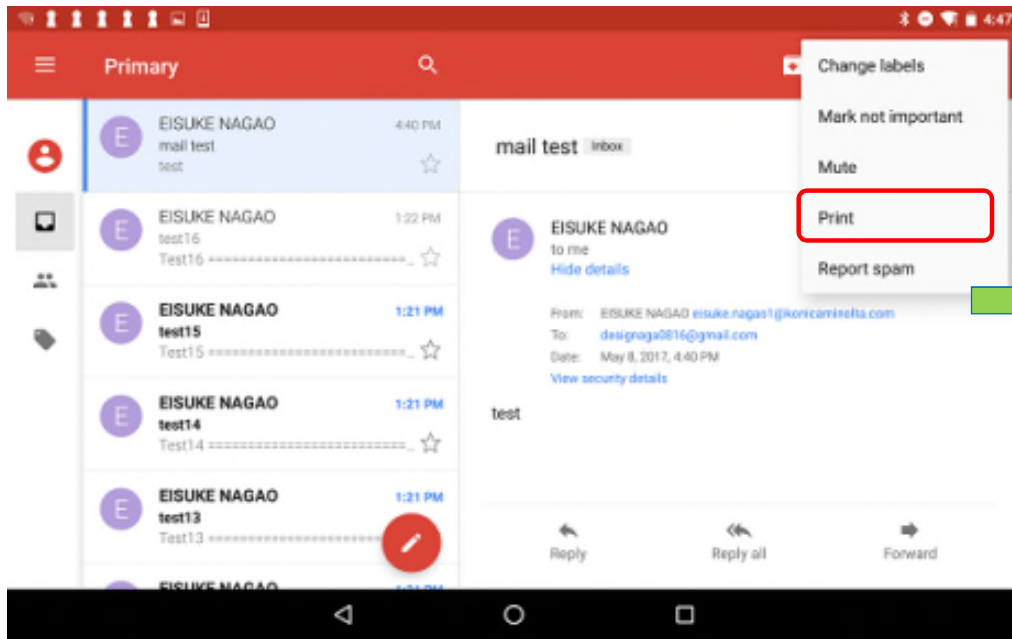

Open Email and tap PRINT

Tap Konica Minolta Mobile Print & execute PRINT job



\*Android Printing Framework function implemented in Android OS 4.4 and later.

# Printing Photos the Album - iOS

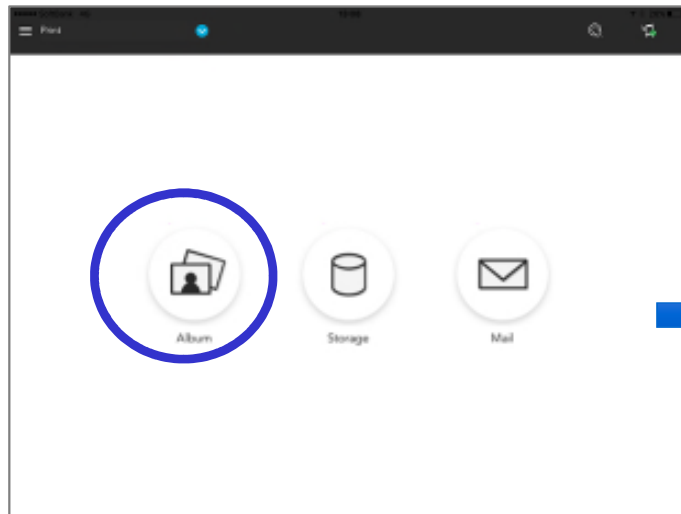

Tap ALBUM icon

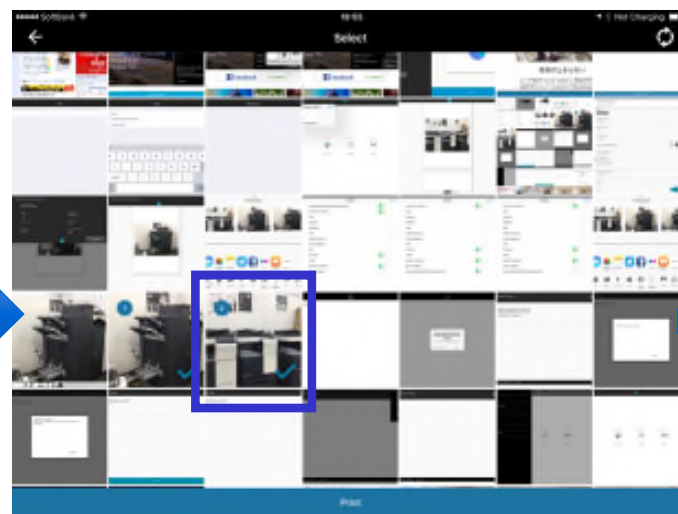

Tap Photo you wish to print

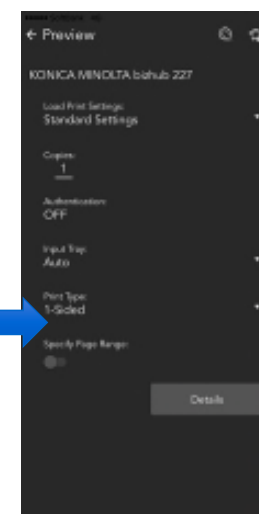

Tap PRINT

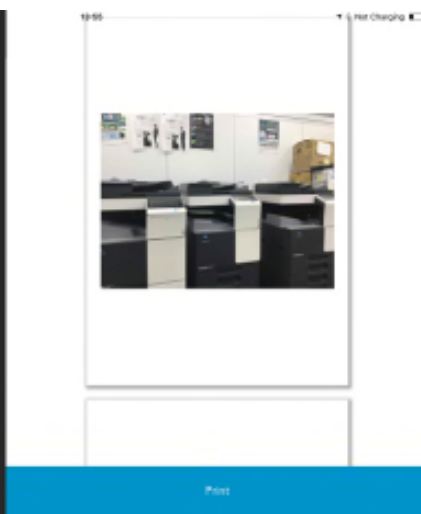

# Printing Photos from the Album - Android

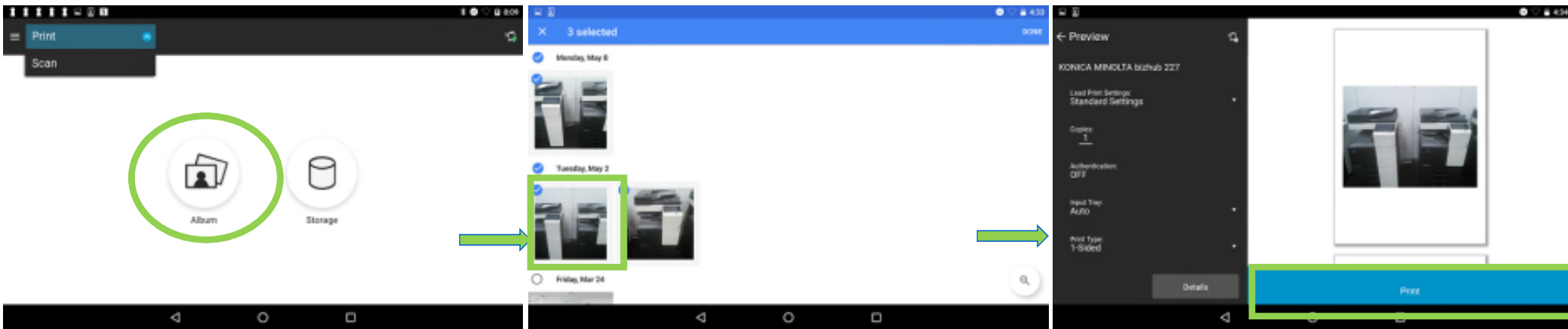

Tap ALBUM

Tap photo you wish to print

Tap PRINT

# Scan Function - iOS

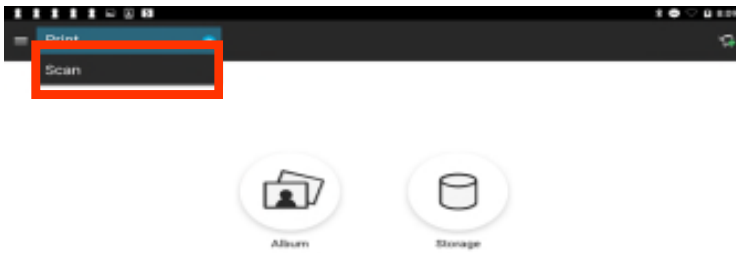

① Select SCAN

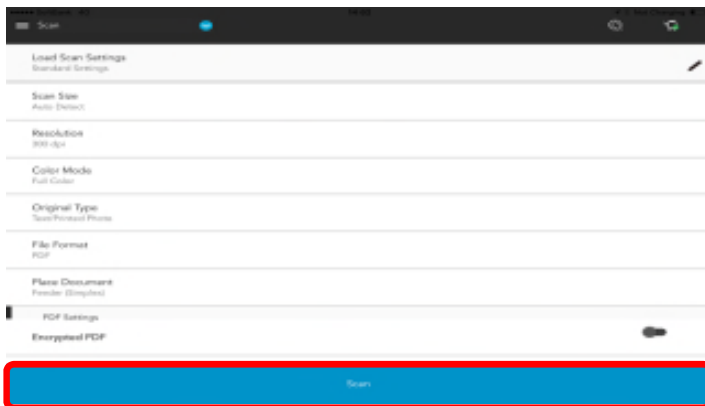

② Select SCAN Settings & Tap SCAN



③ Select Function: DELETE, SAVE or PREVIEW



④ Select desired application to save the scan data (if you wish to save)

# Scan Function - Android

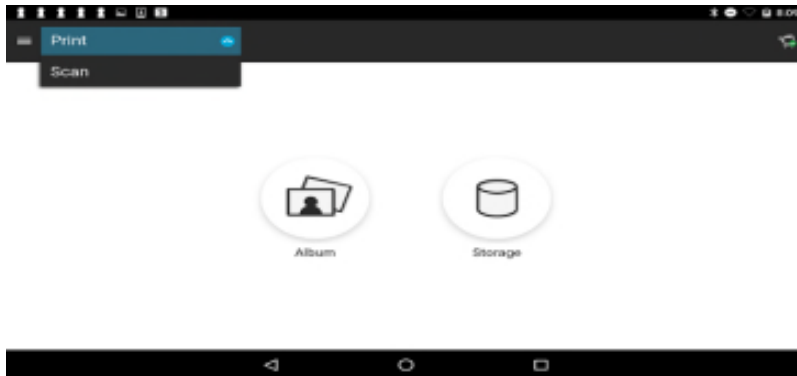

① Select SCAN

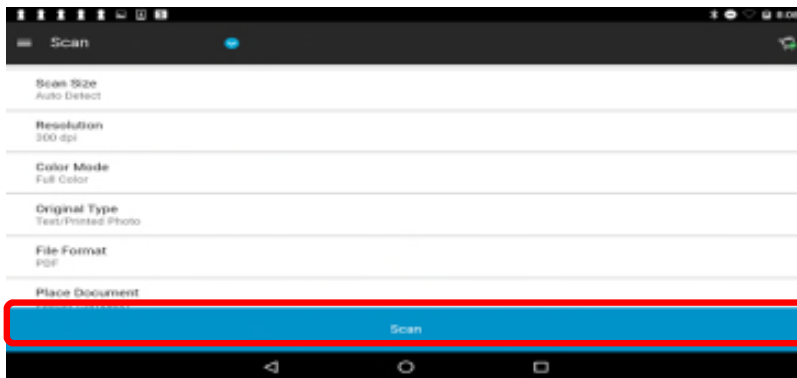

② Select SCAN Settings & Tap SCAN

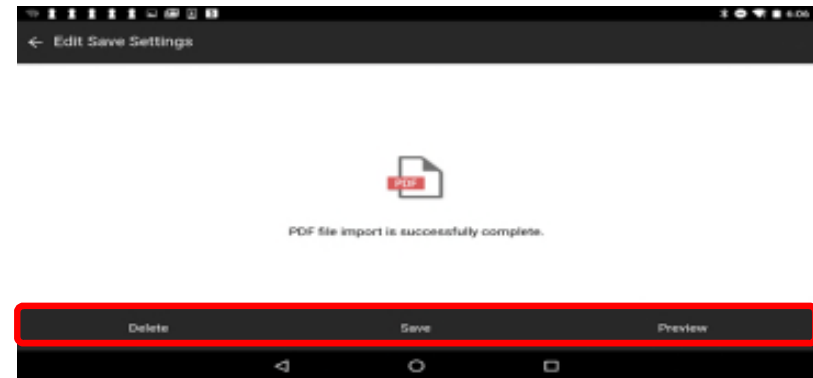

③ Select Function: DELETE, SAVE, PREVIEW



④ Select desired application to save the scan data (if you wish to save)

# Automatic Printer Registration

Automatically search for Konica Minolta engines that are on the same network as the mobile device to register engine in the Konica Minolta Mobile Print App.

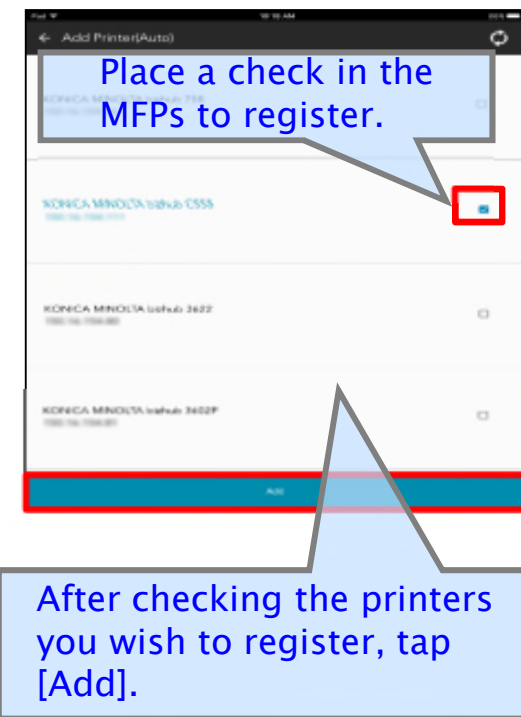
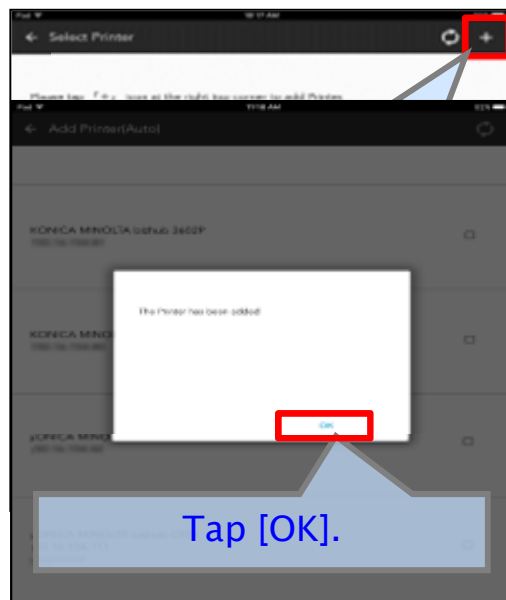

This registration method can be used for iOS, Android, and Windows mobile devices.

# Manual Printer Registration

Manually search for Konica Minolta engines that are on the same network as the mobile device and register the engine in the Konica Minolta Mobile Print App.

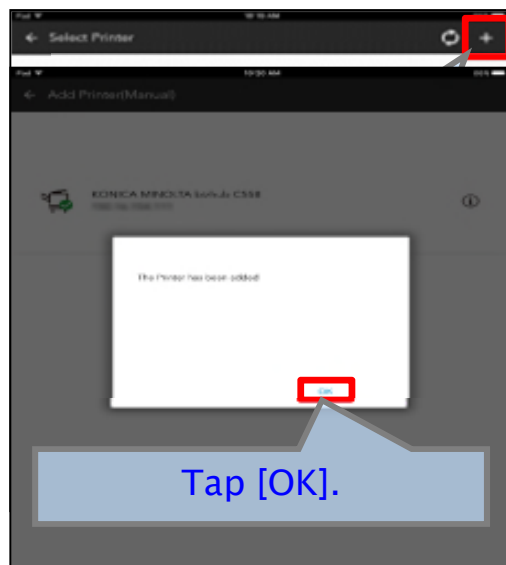

This registration method can be used for iOS, Android, and Windows mobile devices.

# QR Code Printer Registration

Display the QR Codes for Konica Minolta engines that are on the same network as the mobile device and register the engine in the Konica Minolta Mobile Print App.

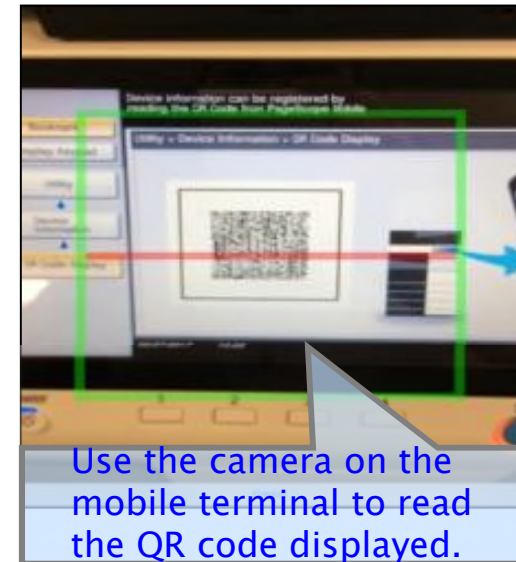
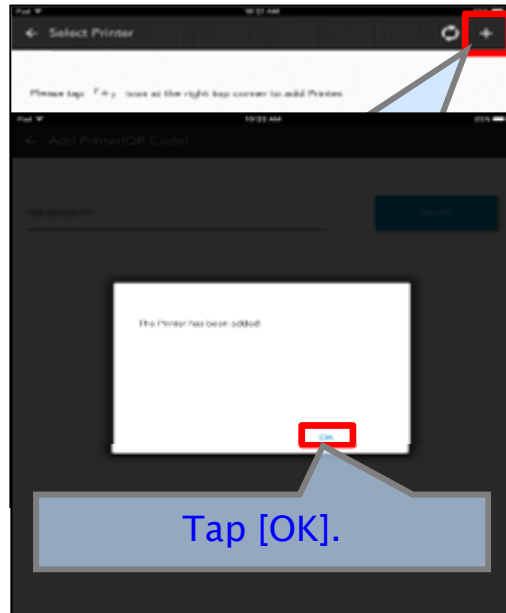

This registration method can be used for iOS, Android, and Windows mobile devices.



# NFC Printer Registration



Register Konica Minolta engines that are on the same network as the mobile device via NFC.

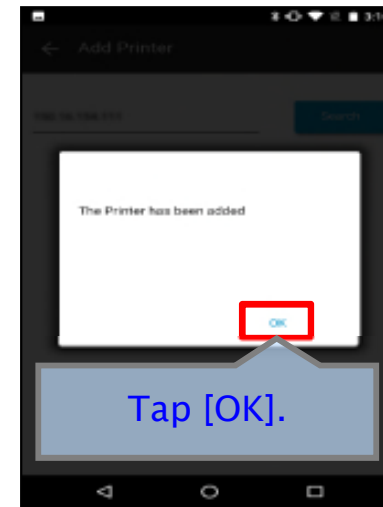
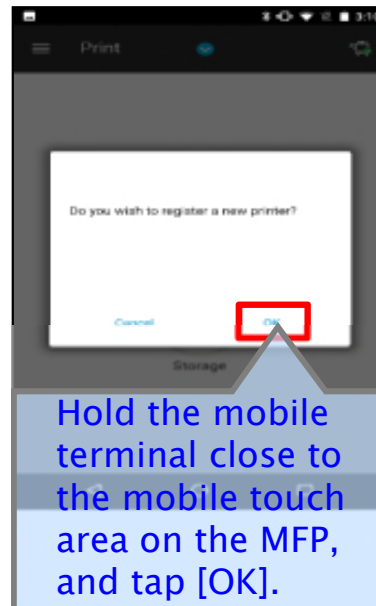

This registration method can ONLY be used with Android devices. NFC must be enabled on the mobile device and MFP first.

# Bluetooth Printer Registration



Register Konica Minolta engines that are on the same network as the mobile device via Bluetooth.

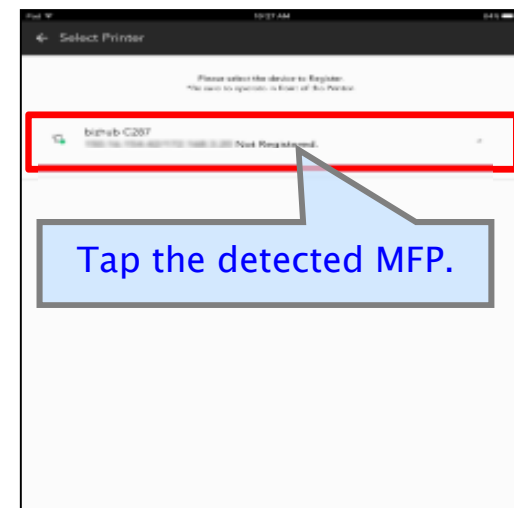
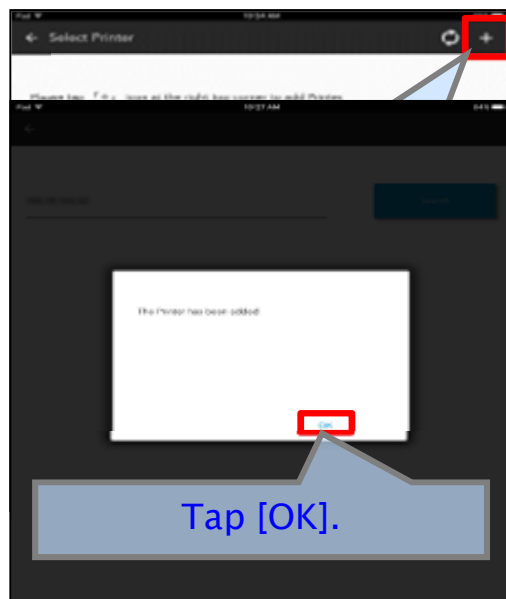

This registration method can be used with iOS devices. Bluetooth must be enabled on the mobile device and MFP first.

# When User Authentication is enabled on MFP

When User Authentication is set on the registered MFPs, enter the authentication information in the Konica Minolta Mobile Print App

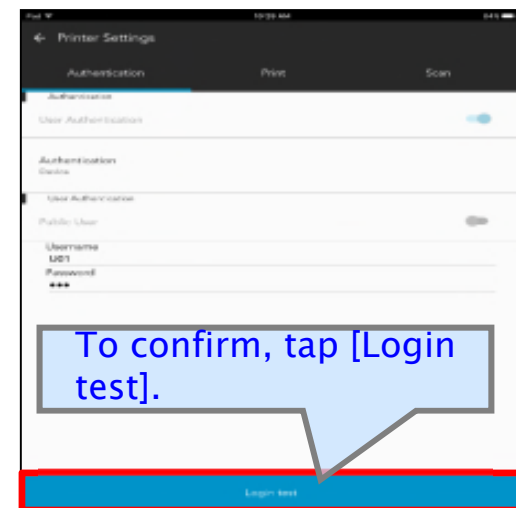
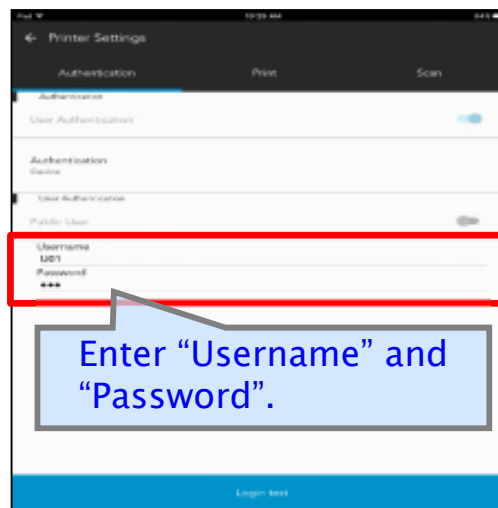

The following methods of authentication can be used to authenticate users:

- Main Unit Authentication
- External Server Authentication
- Expanded Server Authentication
- Main Unit Authentication + External Server Authentication
- Main Unit Authentication + Expanded Server Authentication

# Deleting a Registered Printer

Deleting Konica Minolta printers that are no longer used for mobile printing using the Konica Minolta Mobile Print app.

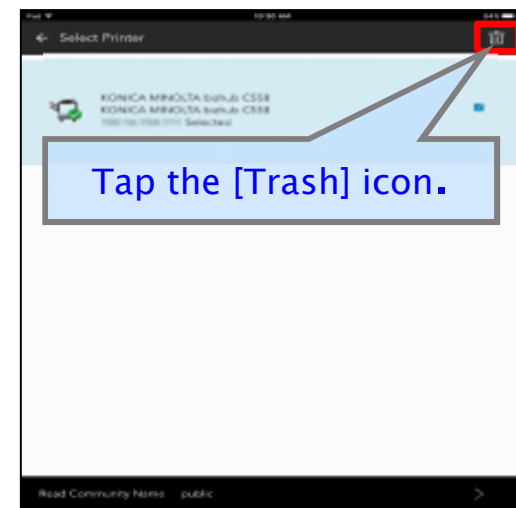
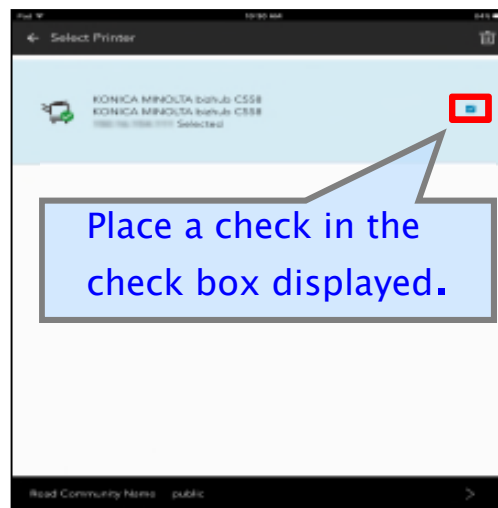
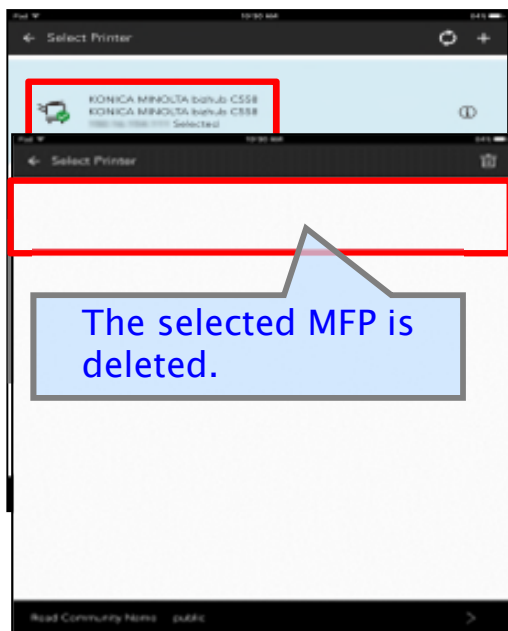

# Uninstalling the Konica Minolta Mobile Print App



1. Press and hold the “Konica Minolta Mobile Print” icon or name.
2. In the menu that appears, tap [Delete] or [X].
3. If the confirmation dialog appears, tap [Yes] or [Delete].

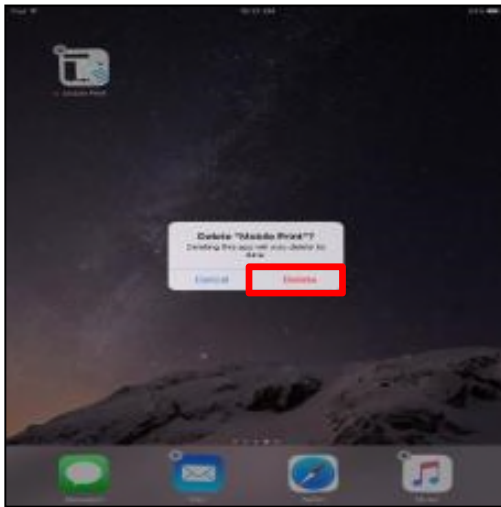

iOS

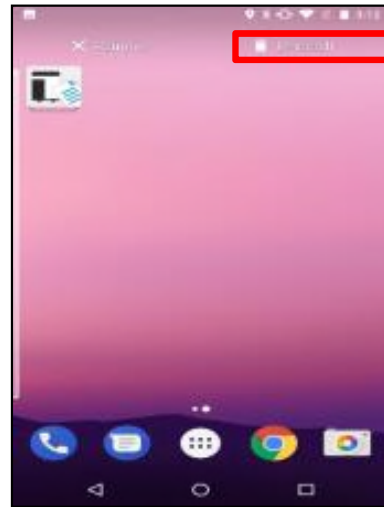

Android

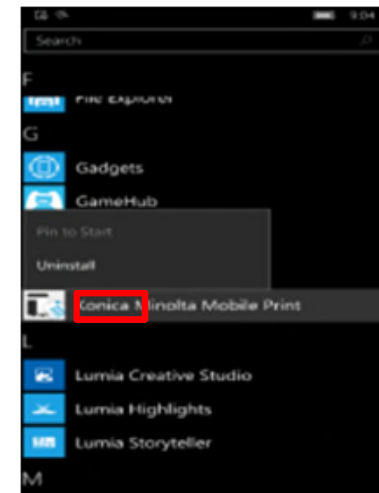

Windows

# Printing Pictures – iOS/Android/Windows

Pictures stored on the mobile device can be printed from the album function.

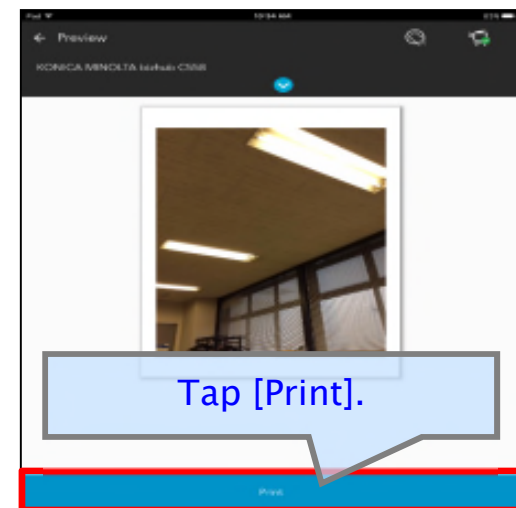
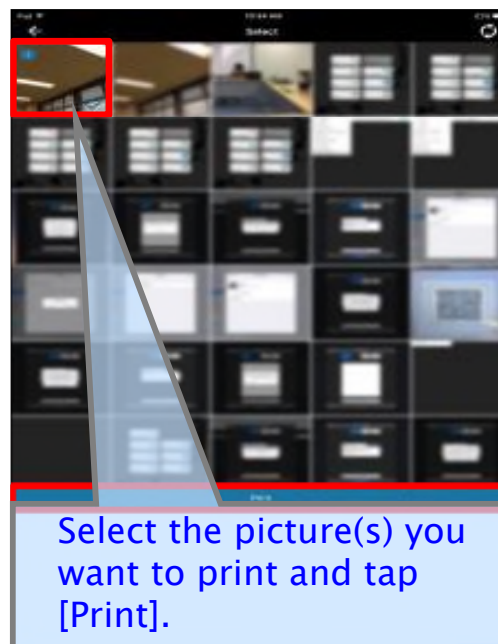
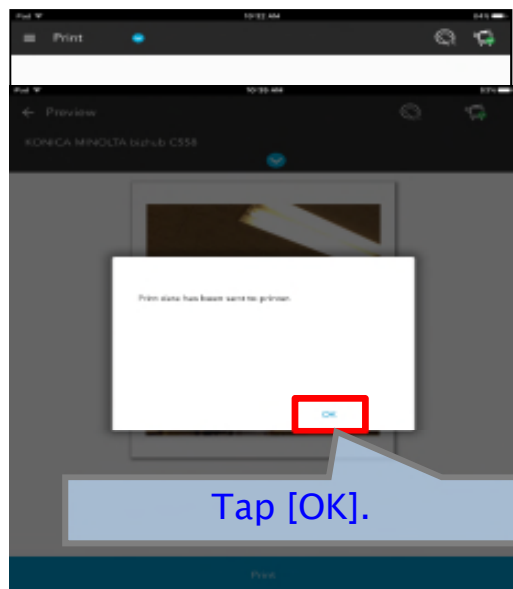

# Printing Emails - iOS

Open an Email from the mail function for printing.

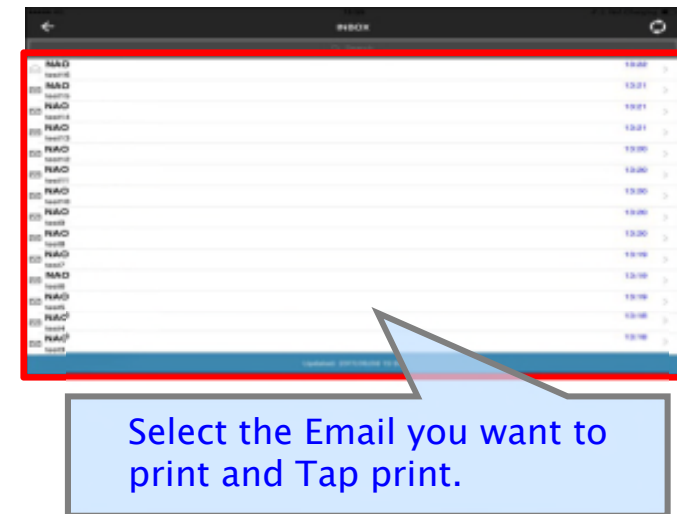
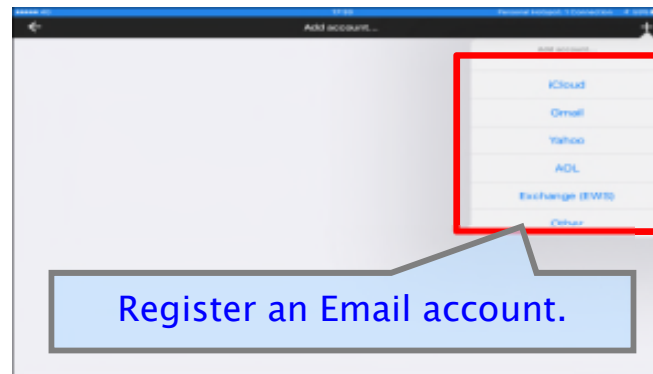
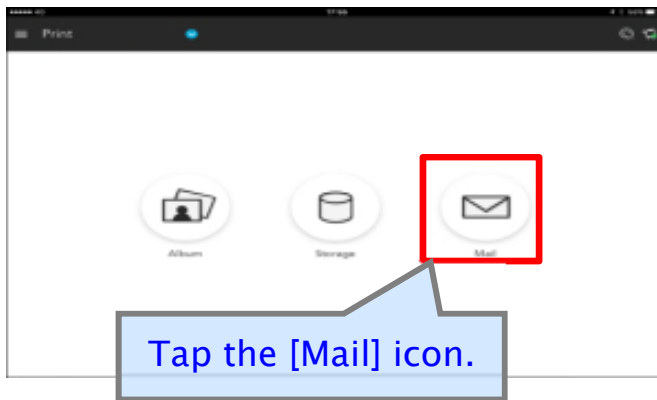

# Printing Emails - Android

Use Printing Framework to print Emails from an external application.



The Konica Minolta Mobile Print App Android version allows linking with external applications to print Emails.



# Printing Emails - Android

Use Printing Framework to print Emails from an external application.



Open the email you wish to print from a browser or Email application.

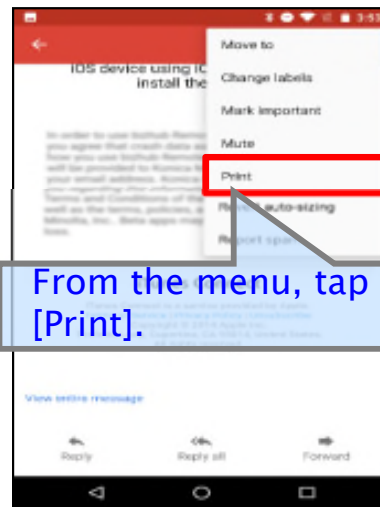

From the menu, tap [Print].

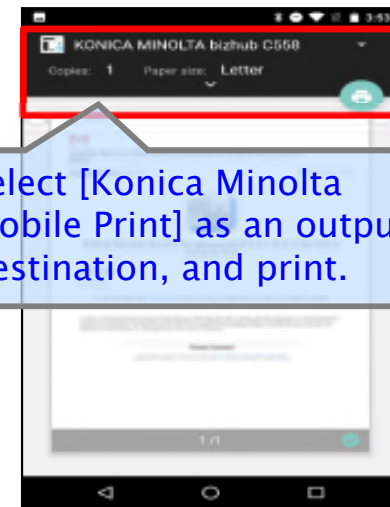

Select [Konica Minolta Mobile Print] as an output destination, and print.

An external application must be used to open Emails when using the Android version of the Konica Minolta Mobile Print App.

# Printing Photos Taken with iOS Camera

You can print photos that have been taken with the iOS camera application.

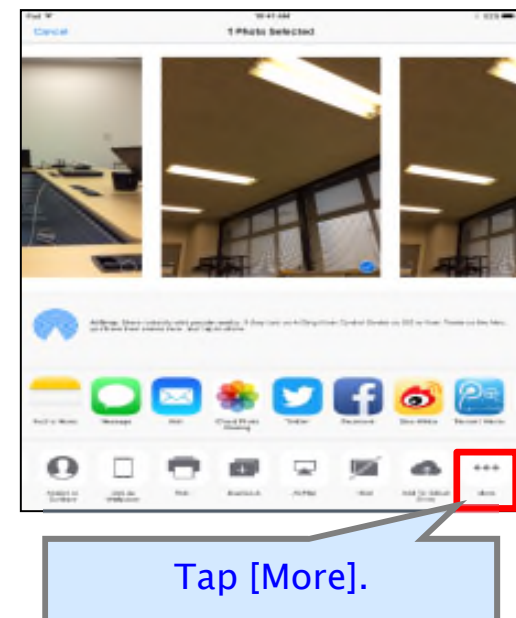
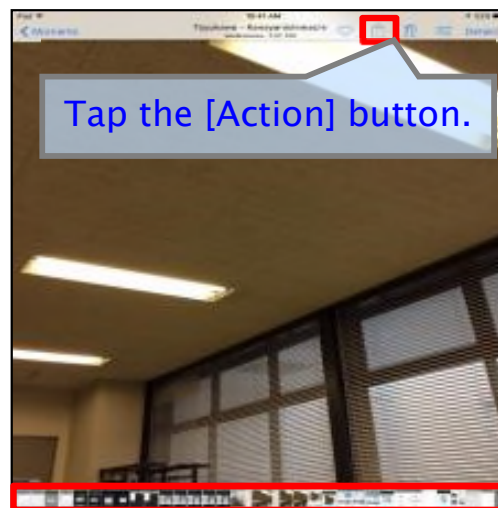
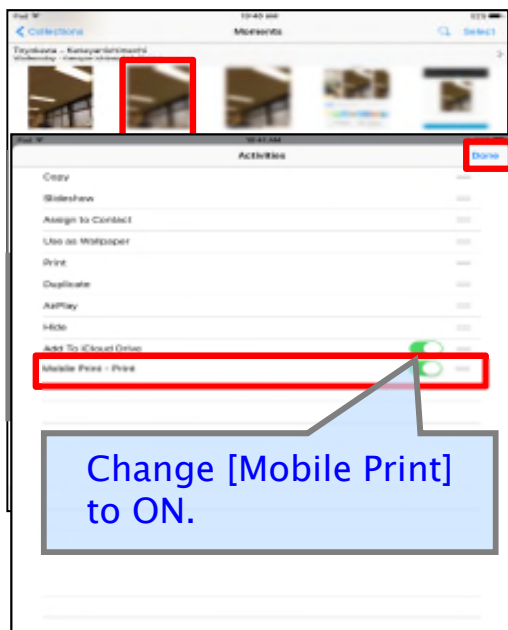

# Printing Photos Taken with iOS Camera



Print iOS Camera photos

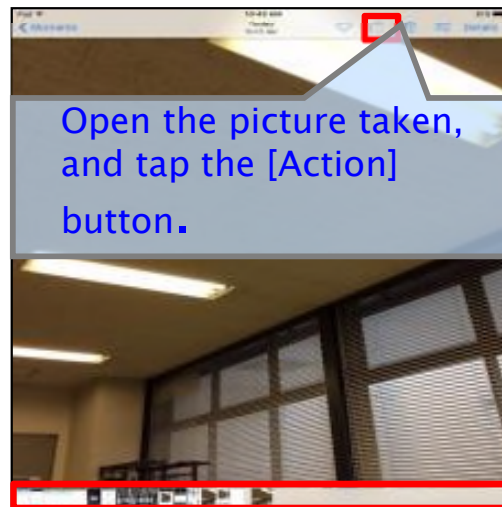
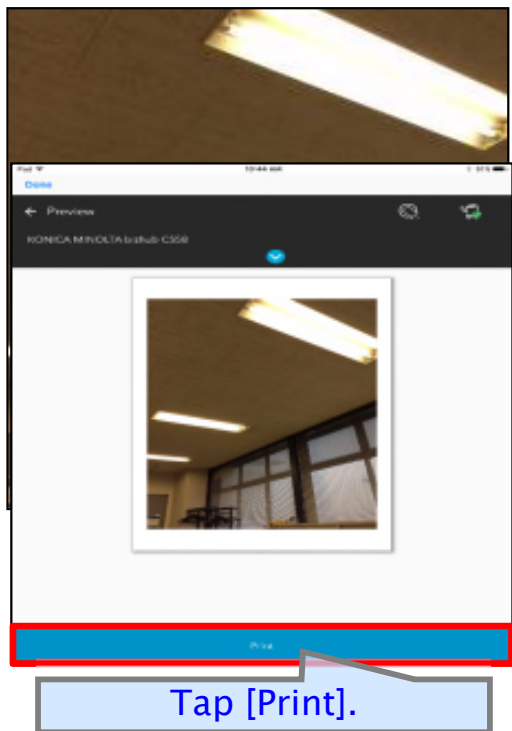

# Printing Photos Taken with Android Camera



Print Android Camera photos

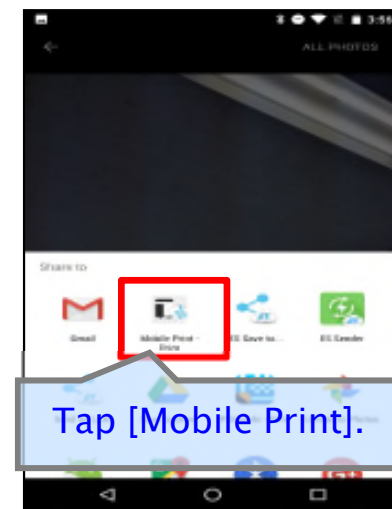
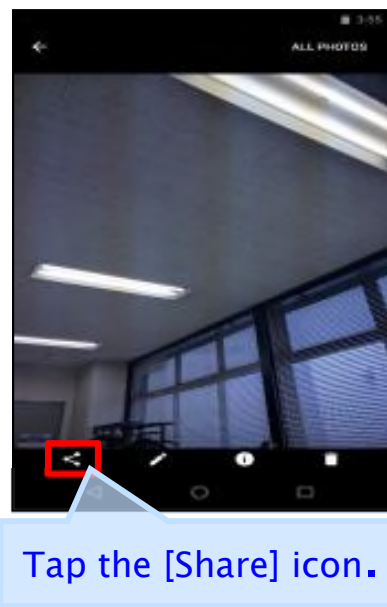
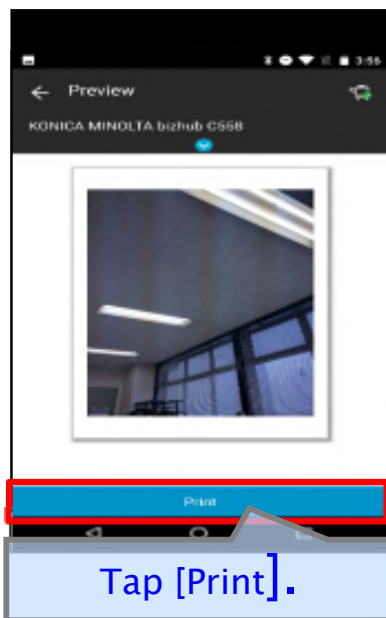

# Printing Photos Taken with Windows Camera



Print Windows Camera photos

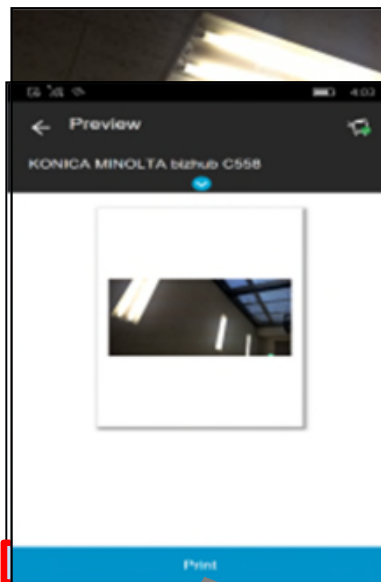

Tap [Print].

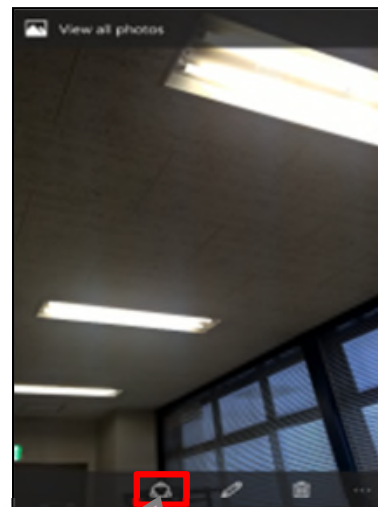

Tap the [Share] icon.

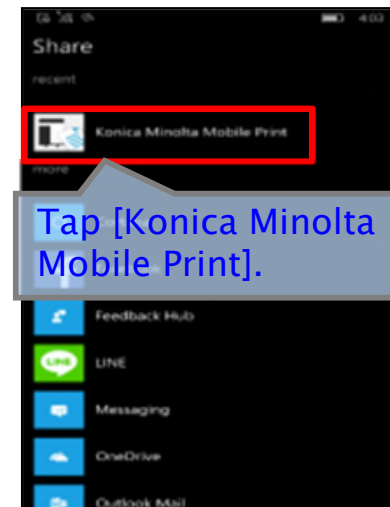

Tap [Konica Minolta Mobile Print].

# Printing Web Pages - iOS



Open a browser application to access a web page you wish to print

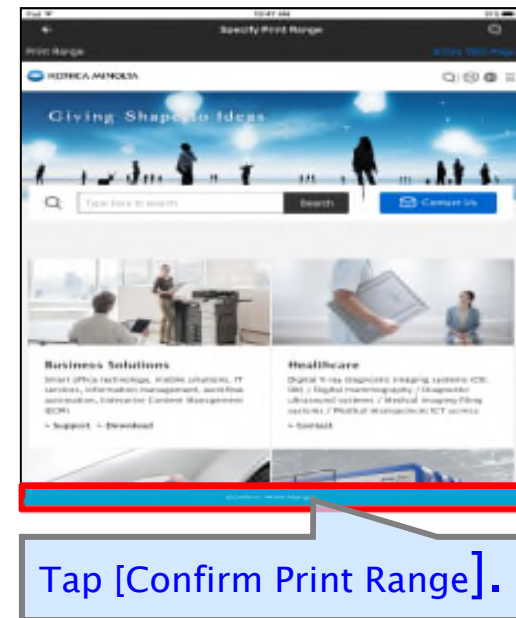

# Printing Web Pages - Android

Open a browser application to access a web page you wish to print

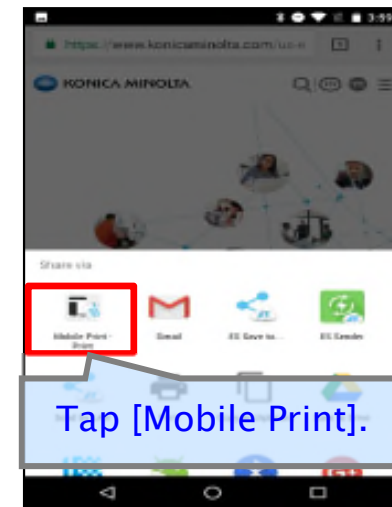
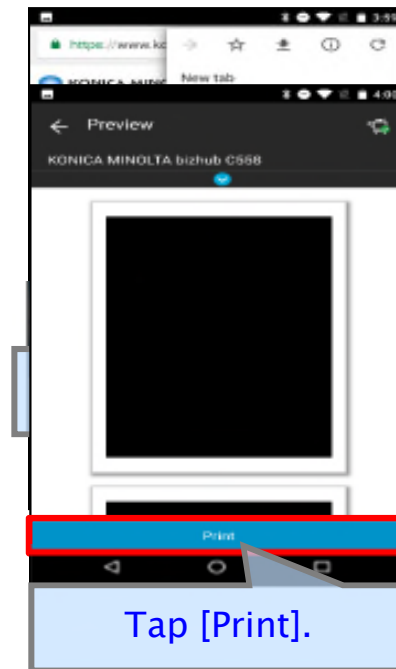

# Printing Web Pages - Windows

Open a browser application to access a web page you wish to print

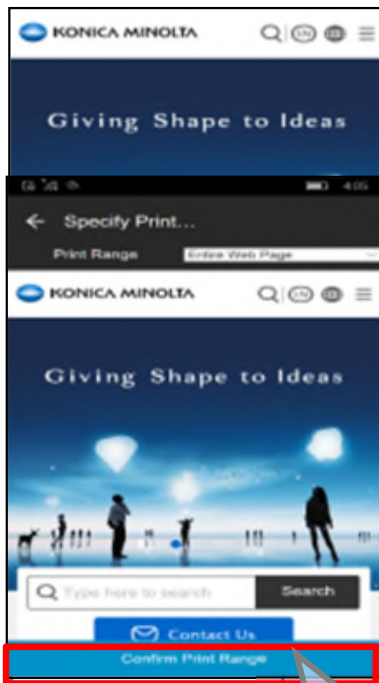

and tap the options menu

Tap [Confirm Print Range].

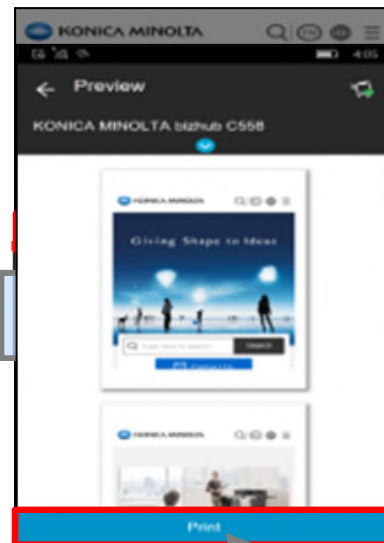

Tap [Print].

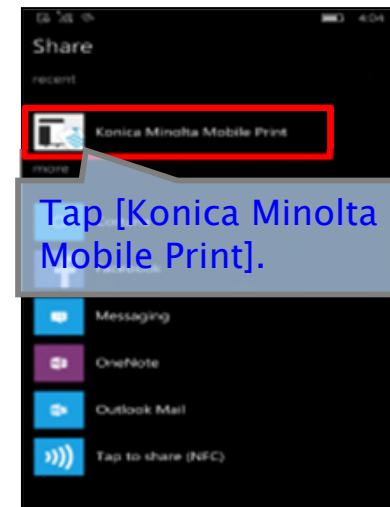

Tap [Konica Minolta Mobile Print].





# Printing Stored Data - iOS

Print files stored locally or in the cloud

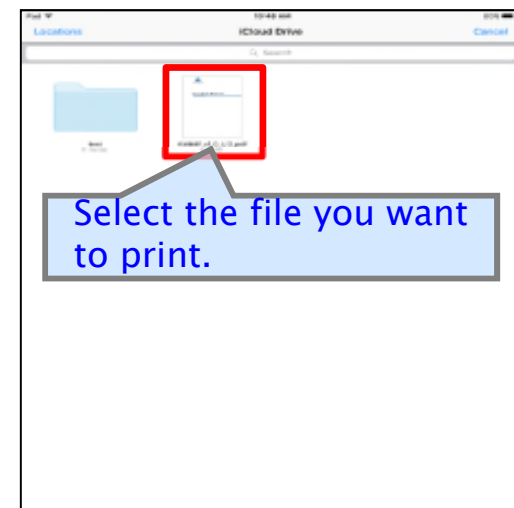
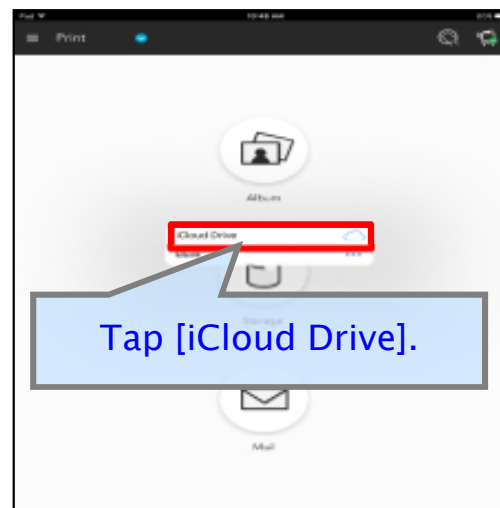

# Printing Stored Data - Android

Print files stored locally or in the cloud

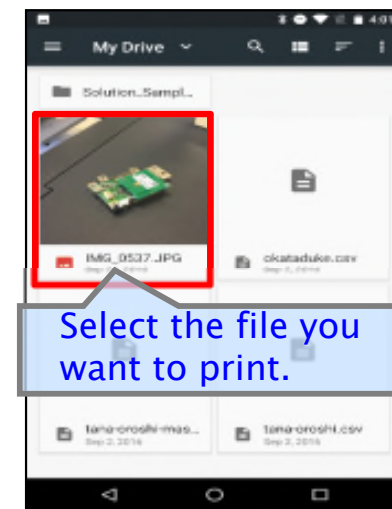
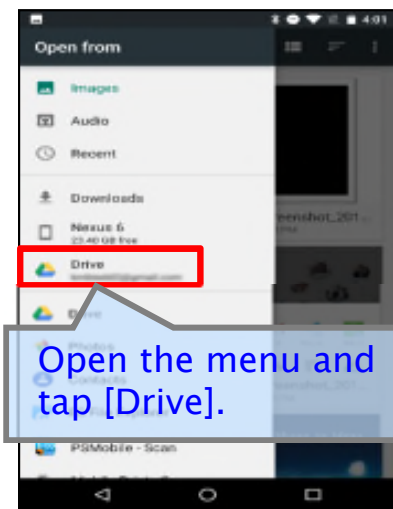
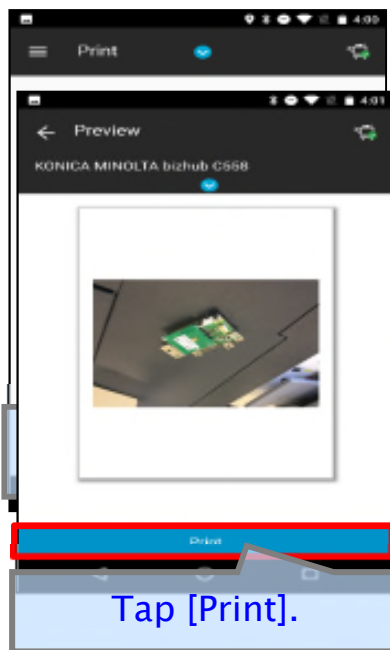

# Printing Stored Data - Windows

Print files stored locally or in the cloud

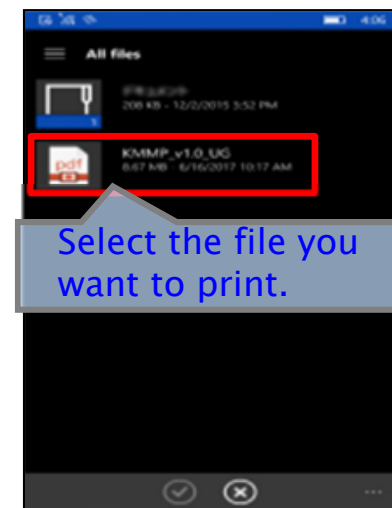
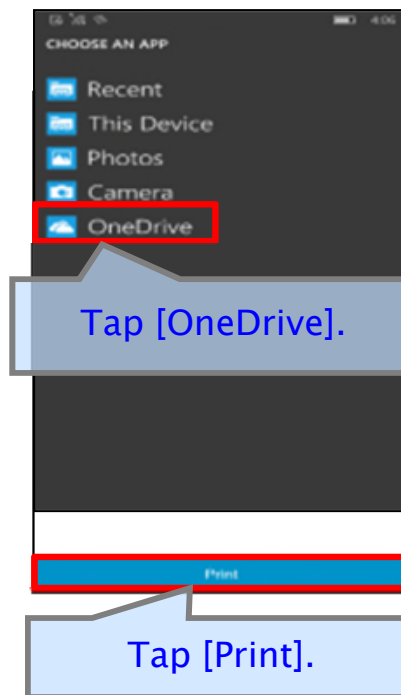
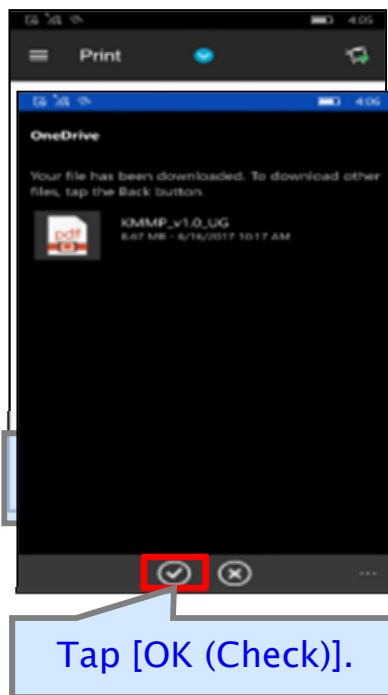

# Scanning & Saving Files – iOS/Android/Windows



Scan a document from the MFP and save it to a mobile device

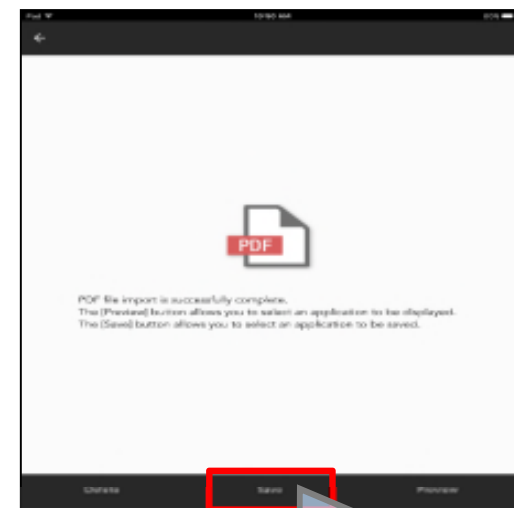
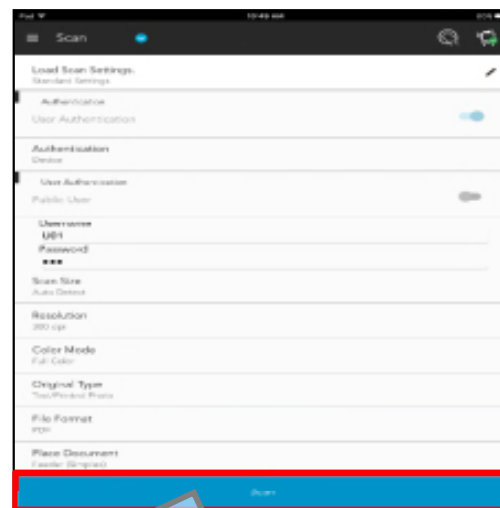
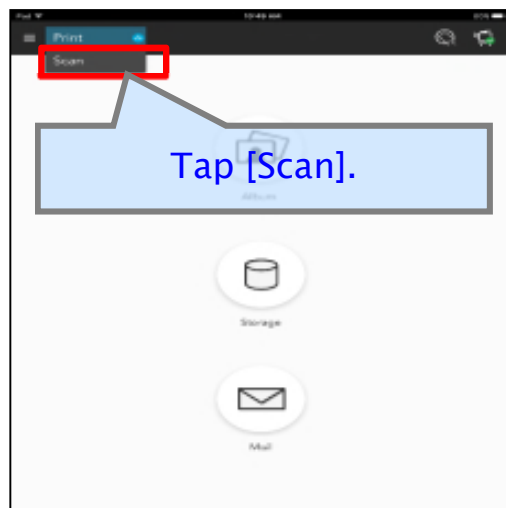

# Konica Minolta Mobile Print Network Compatibility

# Network Compatibility

## Network environment for MFPs without Wireless LAN function

To use Konica Minolta Mobile Print, mobile devices must be connected via Wi-Fi to the same network as the MFPs.

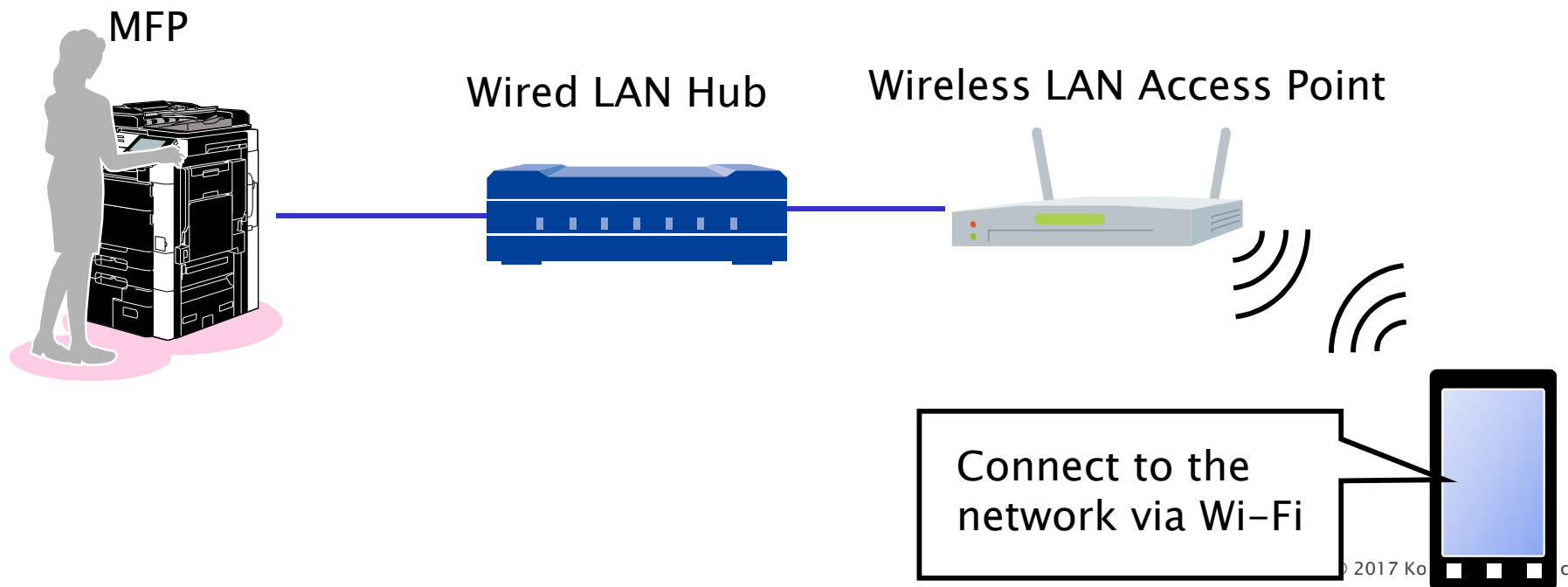

# Network Compatibility

To use Konica Minolta Mobile Print, mobile devices must be connected via Wi-Fi to the same network as the MFPs.

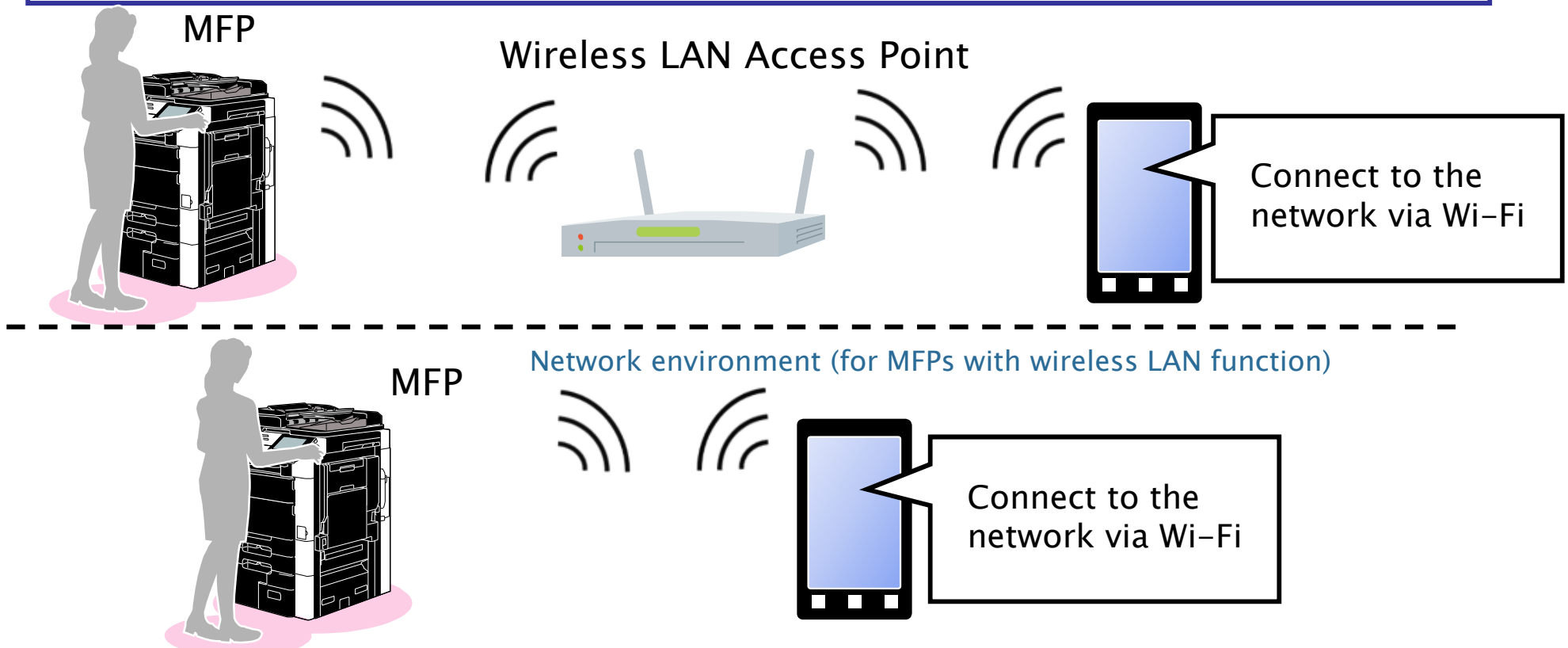

The function compatible to wireless LAN connection is only available to certain models.

# Direct WIRELESS Printing

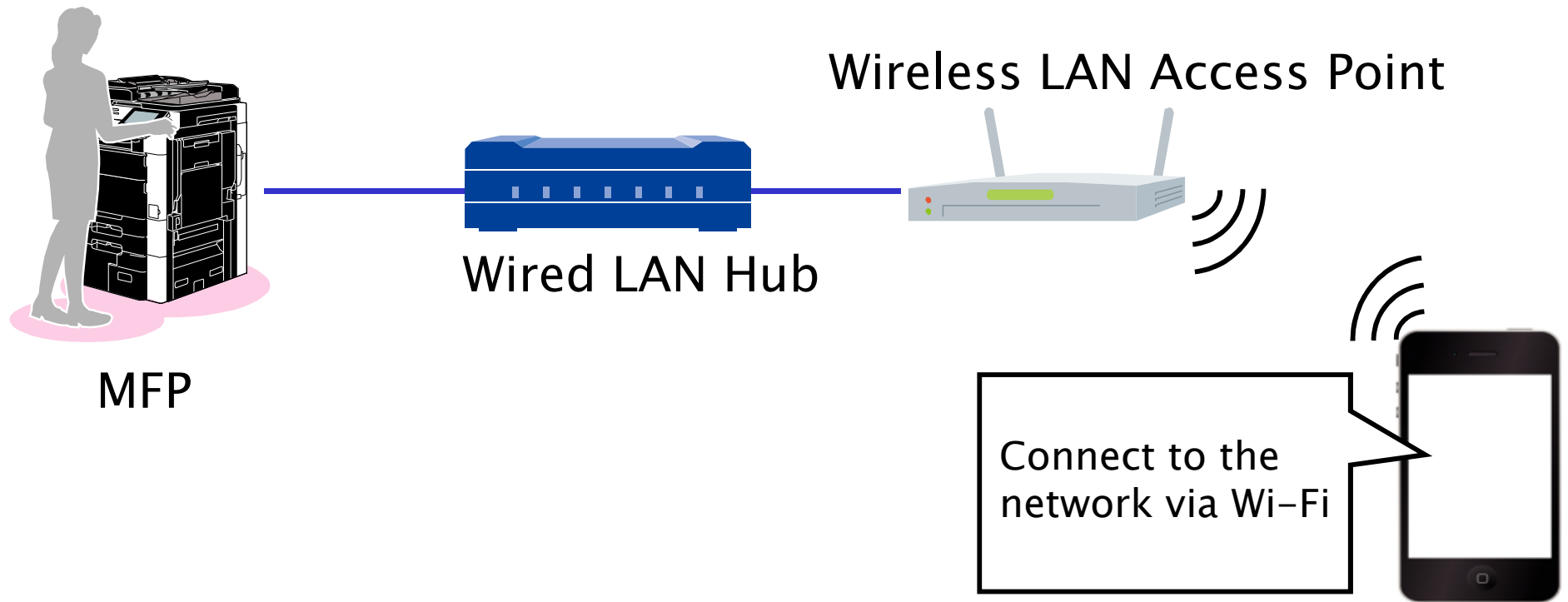





**KONICA MINOLTA**

## Additional Notes for Konica Minolta Mobile Print when registering an Email Exchange/EWS

### For Microsoft Exchange Online / Office 365

1. Access your journaling mailbox account using Outlook Web App (OWA)
2. Click **Options > See All Options > Account > My Account > Settings for POP, IMAP, and SMTP access**
3. In the list of entries, locate the server name. The URL of exchange web service for the mailbox is the URL: [https://<ONLINE\\_URL>/EWS/Exchange.asmx](https://<ONLINE_URL>/EWS/Exchange.asmx)

### For Microsoft Exchange (on premise)

1. The URL can be composed using the following syntax: [https://<EXCHANGE\\_SERVER\\_HOSTNAME>/EWS/Exchange.asmx](https://<EXCHANGE_SERVER_HOSTNAME>/EWS/Exchange.asmx)

### Using Microsoft Exchange Management Shell

1. Open Exchange Management Shell and run the following command.
2. `Get-WebServicesVirtualDirectory |Select name, *url* | fl`

The output will be similar to the following:

Name : EWS (Default Web Site)  
InternalNLBBypassUrl : <https://server name/ews/exchange.asmx>  
InternalUrl : <https://server name/EWS/Exchange.asmx>  
ExternalUrl : <https://mail.domain.com/ews/exchange.asmx>